



RoHS

TOPTEK®  
HARDWARE ELECTRONIC MANUFACTURER



## Female Header 2.54mm 1 Row H=8.5mm Right Angle Type

### Specifications

Current Rate:3 AMP  
Insulation Resistance:1000MΩ Min.  
Contact Resistance:20mΩ Max.  
Dielectric Voltage:1000V AC for one minute  
Operation Temperature:-40°C to +105°C

### Material

Insulator:Hi-Temp. Thermoplastic, UL 94V-0  
Terminal:Copper Alloy  
Plating:Gold Plated

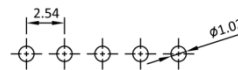
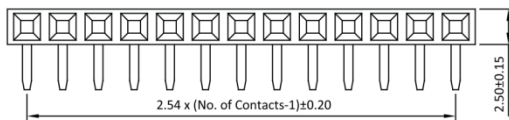

Recommended PCB Layout  
(PCB TOLERANCE ±0.05)

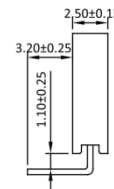
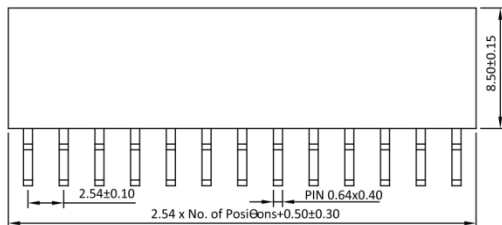

Part No.:PS1R85-1XX-L/U

## ORDER INFORMATION

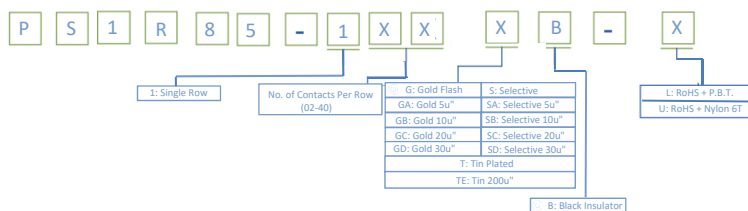

©:Standard Recommend

